

CATALOG NUMBER : 07H7D0E

.62 (15.7mm)
DIA PIN

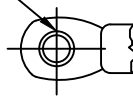

.69 (17.5mm)
DIA HOLE

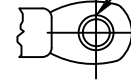

28.75 (730.3mm)

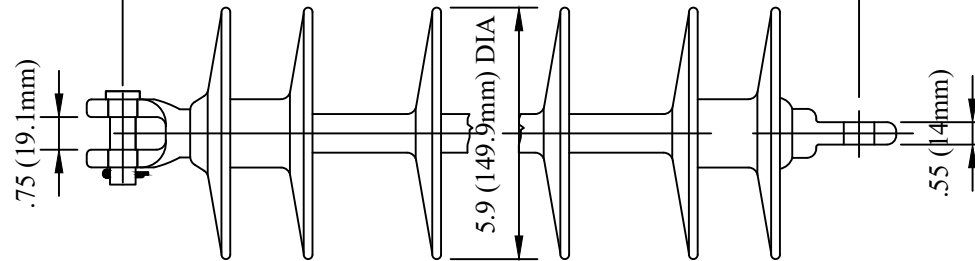

DESIGN CHARACTERISTICS

DRY ARC DISTANCE	29 IN
LEAKAGE DISTANCE	69 IN
60 HZ DRY FLASHOVER	315 KV
60 HZ DRY WITHSTAND	305 KV
60 HZ WET FLASHOVER	245 KV
60 HZ WET WITHSTAND	230 KV
IMPULSE CRITICAL POSITIVE	500 KV
IMPULSE CRITICAL NEGATIVE	510 KV
MAX. RIV AT 1000 KHZ	10 μV
RIV TEST VOLTAGE	32 KV
POWER ARC	150 KA CYCLES
NET WEIGHT	6 LBS
TENSION PROOF TEST	10,000 LBS
ULTIMATE TENSION STRENGTH	1,000 LBS
NO. OF WEATHERSHEDS	10

DRN BY:	DATA
Ella	08/06/17
<small>CONFIDENTIAL THIS DRAWING AND ITS CONTENTS PROPERTY OF TIANJIN TUOFA ELECTRIC POWER TECHNOLOGY CO.,LTD. NO PUBLICATION, DISTRIBUTION OR COPIES MAY BE MADE WITHOUT THE WRITTEN CONSENT OF TIANJIN TUOFA ELECTRIC POWER TECHNOLOGY CO.,LTD. TIANJIN TUOFA ELECTRIC POWER TECHNOLOGY CO.,LTD UNPUBLISHED ALL RIGHTS RESERVED UNDER THE COPYRIGHT LAWS.</small>	

SUSPENSION CLEVIS
TONGUE INSULATOR



TTF POWER TECHNOLOGY CO.