

CATALOG NUMBER : 05B1T3L

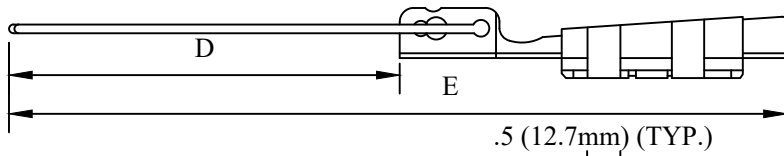

.5 (12.7mm) (TYP.)

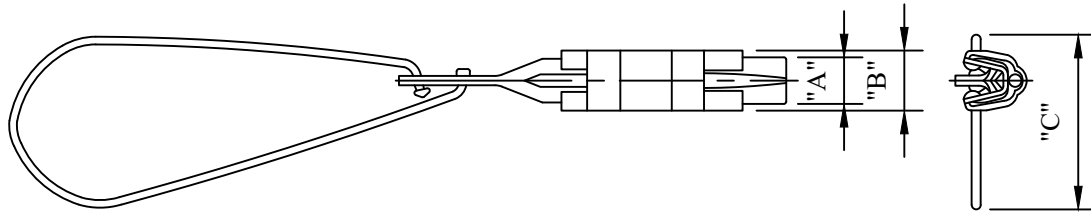
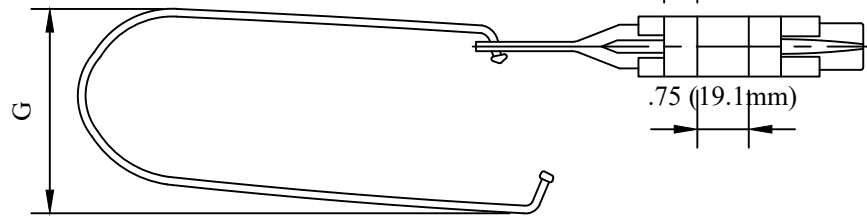
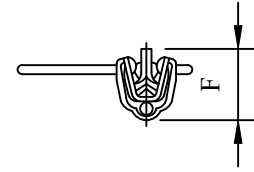

.75 (19.1mm)

CATALOG NUMBER	CONDUCTOR APPLICATION	DIMENSIONS IN INCHES						
		A	B	C	D	E	F	G
05B1T3L_1	ACSR/AAAC #2-#6 AWG	.72	.92	2.5	6.0	11.9	1.1	3.1
05B1T3L_2	AAAC #1 STR. - #6 SOL. AWG DIA. RANGE: .160-.332	.72	.92	5.1	10.2	16.1	1.1	5.1
05B1T3L_3	ACSR/AAAC 1/0-#4 AWG	1.0	1.3	2.5	5.8	12.3	1.4	3.2
05B1T3L_4	AAAC 2/0 STR. - #2 SOL. AWG DIA. RANGE: .248-.414	1.0	1.3	5.1	10.5	17.0	1.4	5.1
05B1T3L_5	ACSR/AAAC 4/0-2/0 AWG	1.2	1.4	2.7	5.7	12.9	1.5	3.4
05B1T3L_5	AAAC 4/0-2/0 AWG DIA. RANGE: .414-.565	1.2	1.4	5.1	10.1	17.2	1.5	5.0

NOTES:

- 1.PARTS PERFORMANCE TESTED REFERENCING ANSI C119.4 PULLOUT.
- 2.FOR "GOLDEN", ANTI-CORROSION COATING VERSION, ADD "I" TO THE END OF THE CATALOG NUMBER IN TABLE.

DRN BY:	DATA
Ella	09/07/17
<small>CONFIDENTIAL THIS DRAWING AND ITS CONTENTS PROPERTY OF TIANJIN TUOFA ELECTRIC POWER TECHNOLOGY CO.,LTD. NO PUBLICATION, DISTRIBUTION OR COPIES MAY BE MADE WITHOUT THE WRITTEN CONSENT OF TIANJIN TUOFA ELECTRIC POWER TECHNOLOGY CO.,LTD. TIANJIN TUOFA ELECTRIC POWER TECHNOLOGY CO.,LTD UNPUBLISHED ALL RIGHTS RESERVED UNDER THE COPYRIGHT LAWS.</small>	

ALUMINUM
WEDGE DEADEND



TTF POWER TECHNOLOGY CO.