

CATALOG NUMBER : 07B139F

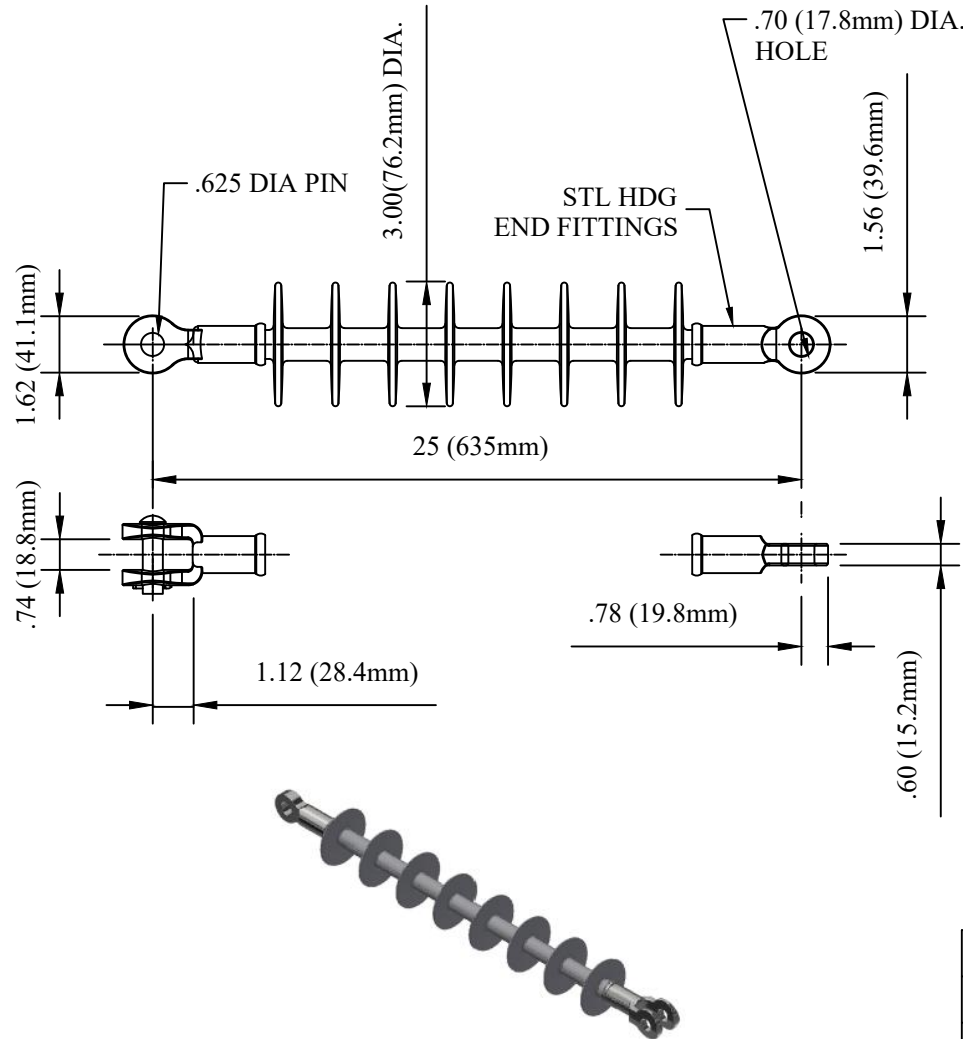

MECHANICAL VALUES  
 TENSILE PROOF TEST 10000 LBS 45 KN  
 ULTIMATE TENSION STRENGTH 15000 LBS 70 KN

ELECTRICAL VALUES  
 60 HZ DRY FLASHOVER (DRY WITHSTAND) 200 KV (170) KV  
 60 HZ DRY FLASHOVER (WET WITHSTAND) 160 (130) KV  
 CRITICAL IMPLUSE FLASHOVER + (WITHSTAND) 325 - KV  
 CRITICAL IMPLUSE FLASHOVER - (WITHSTAND) 360 - KV  
 MAX RIV AT 1000KHZ <10 μV  
 RIV TEST VOLTAGE 30 KV  
 POWER ARC 150KA CYCLES

DIMENSIONAL VALUES  
 SECTION LENGTH 25.0 IN. 635.0 MM  
 SHED DIAMETER 3.0 IN. 76.2 MM  
 SHEATH THICKNESS ≥0.12 IN. ≥3 MM  
 LEAKAGE DISTANCE 33.0 IN. 838.2 MM  
 DRY ARC DISTANCE 20.0 IN. 508.0 MM

OTHER DETAILS

INSULATOR CLASS N/A  
 NO OF WEATHERSHED: 8  
 WEIGHT: 3.3 LBS  
 COUNTRY OF ORIGIN: USA

NOTES:

- 1.SILICON RUBBER SHEATH AND SHEDS.HIGH PRESSURE WASHABLE SILICON RUBBER HOUSING
- 2.ELECTRICAL CHARACTERISTICS IN ACCORDANCE WITH ANSI C29.13,CSA C411.5-10 AND IEC 61109.

DRN BY:	DATA
Ella	10/08/16
<small>CONFIDENTIAL THIS DRAWING AND ITS CONTENTS PROPERTY OF TIANJIN TUOFA ELECTRIC POWER TECHNOLOGY CO.,LTD. NO PUBLICATION, DISTRIBUTION OR COPIES MAY BE MADE WITHOUT THE WRITTEN CONSENT OF TIANJIN TUOFA ELECTRIC POWER TECHNOLOGY CO.,LTD. TIANJIN TUOFA ELECTRIC POWER TECHNOLOGY CO.,LTD UNPUBLISHED ALL RIGHTS RESERVED UNDER THE COPYRIGHT LAWS.</small>	

VERI\*LITE PDI DEADEND  
 INSULATOR (SILICONE)



TTF POWER TECHNOLOGY CO.