

CATALOG NUMBER : 05E1Q6I

PRODUCT DATA & CONDUCTOR SIZE							
CATALOG NUMBER	CONDUCTOR RANGE (AWG)		DIMENSIONS INCHES(MM)				APPROX. WT. EACH LBS.(KG)
	MAIN	TAP	L	W	H	J	
ST3	#8 SOL.- 2/0 STR.CU #8 A - 2/0 F CW 1/8"- 7/16" CW/GS .125" - .438"	#8 SOL.- 2/0 STR.CU #9 1/2D - 2/0 F CW 1/8"- 7/16" CW/GS .125" - .438"	7/8 (22.2)	1-1/2 (38.1)	1-1/2 (38.1)	5/16 (7.9)	.22 (9.98)
ST4	#6 SOL.- 4/0 STR.CU #6 A - 4/0 F CW 1/4"- 9/16" CW/GS .162" - .562"	#6 SOL.- 4/0 STR.CU #6 A - 4/0 F CW 1/4"- 9/16" CW/GS .162" - .562"	15/16 (23.8)	1-7/8 (47.6)	1-1/2 (38.1)	3/8 (9.5)	.30 (13.61)

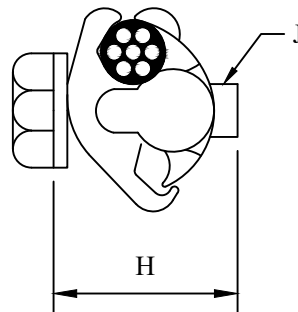
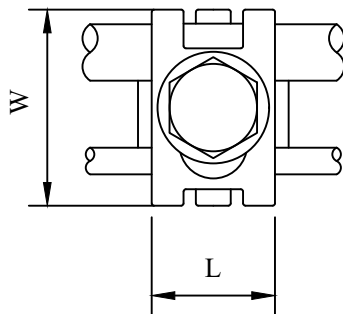

NOTES:

1.MATERIAL:

BODY - HIGH STRENGTH BRONZE ALLOY

HARDWARE - SILICON BRONZE OR STAINLESS STEEL

DRN BY:	DATA
Ella	07/09/16
<small>CONFIDENTIAL THIS DRAWING AND ITS CONTENTS PROPERTY OF TIANJIN TUOFA ELECTRIC POWER TECHNOLOGY CO.,LTD. NO PUBLICATION, DISTRIBUTION OR COPIES MAY BE MADE WITHOUT THE WRITTEN CONSENT OF TIANJIN TUOFA ELECTRIC POWER TECHNOLOGY CO.,LTD. TIANJIN TUOFA ELECTRIC POWER TECHNOLOGY CO.,LTD UNPUBLISHED ALL RIGHTS RESERVED UNDER THE COPYRIGHT LAWS.</small>	

PARALLEL GROOVE CONNECTOR



TTF POWER TECHNOLOGY CO.