

CATALOG NUMBER : 07B1K8X

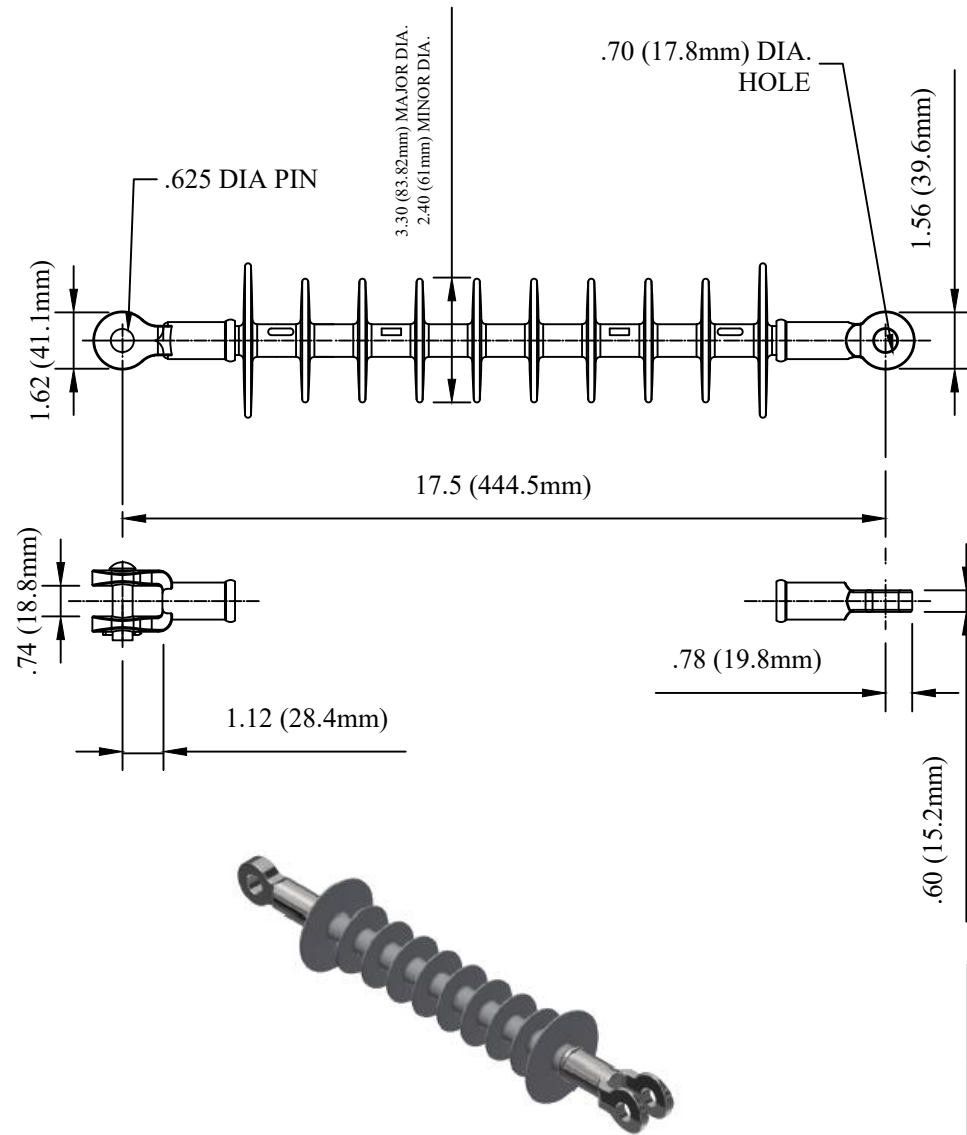

MECHANICAL VALUES
 TENSILE PROOF TEST
 ULTIMATE TENSION STRENGTH

LBS	KN
10000	45
15000	70

ELECTRICAL VALUES
 60 HZ DRY FLASHOVER (DRY WITHSTAND)
 60 HZ DRY FLASHOVER (WET WITHSTAND)
 CRITICAL IMPLUSE FLASHOVER + (WITHSTAND)
 CRITICAL IMPLUSE FLASHOVER - (WITHSTAND)
 MAX RIV AT 1000KHZ
 RIV TEST VOLTAGE
 POWER ARC

KV	KV
140	(115)
120	(105)
235	-
250	-
<10 μV	
30 KV	
150 KA CYCLES	

DIMENSIONAL VALUES
 SECTION LENGTH
 MAJOR SHED DIAMETER
 MINOR SHED DIAMETER
 SHEATH THICKNESS
 LEAKAGE DISTANCE
 DRY ARC DISTANCE

IN.	MM
17.5	444.5
3.30	83.82
2.40	60.96
≥0.12	≥3
26.0	660.4
12.5	320.04

OTHER DETAILS

INSULATOR CLASS DS-28
 NO OF WEATHERSHED: 10
 WEIGHT: 2.5 LBS
 COUNTRY OF ORIGIN: USA/MEXICO

NOTES:

- 1.ESP RUBBER SHEATH AND SHEDS.HIGH PRESSURE WASHABLE ESP RUBBER HOUSING
- 2.ELECTRICAL CHARACTERISTICS IN ACCORDANCE WITH ANSI C29.13,CSA C411.5-10 AND IEC 61109.

DRN BY:	DATA
Ella	07/09/16

ESP RUBBER DEADEND INSULATOR,
 WEIGHT: 2.61 LB

CONFIDENTIAL THIS DRAWING AND ITS CONTENTS PROPERTY OF TIANJIN TUOFA ELECTRIC POWER TECHNOLOGY CO.,LTD. NO PUBLICATION, DISTRIBUTION OR COPIES MAY BE MADE WITHOUT THE WRITTEN CONSENT OF TIANJIN TUOFA ELECTRIC POWER TECHNOLOGY CO.,LTD. TIANJIN TUOFA ELECTRIC POWER TECHNOLOGY CO.,LTD UNPUBLISHED ALL RIGHTS RESERVED UNDER THE COPYRIGHT LAWS.



TTF POWER TECHNOLOGY CO.