

CATALOG NUMBER : 01A2B6K

APPLICATION RANGE	STRAND SIZE & CONSTRUCTION	MAXIMUN RBS	DIM A	DIM B	DIM C
0.516 TO 0.535 [13.11 TO 13.59]	25M	25000 [111.2]	43.00 [1092.2]	36.7 [932]	1.188 [30.18]

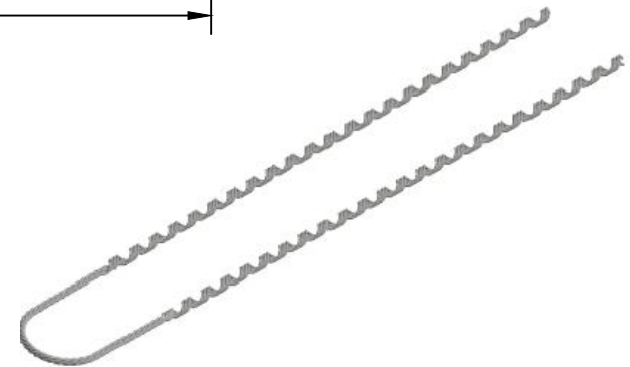
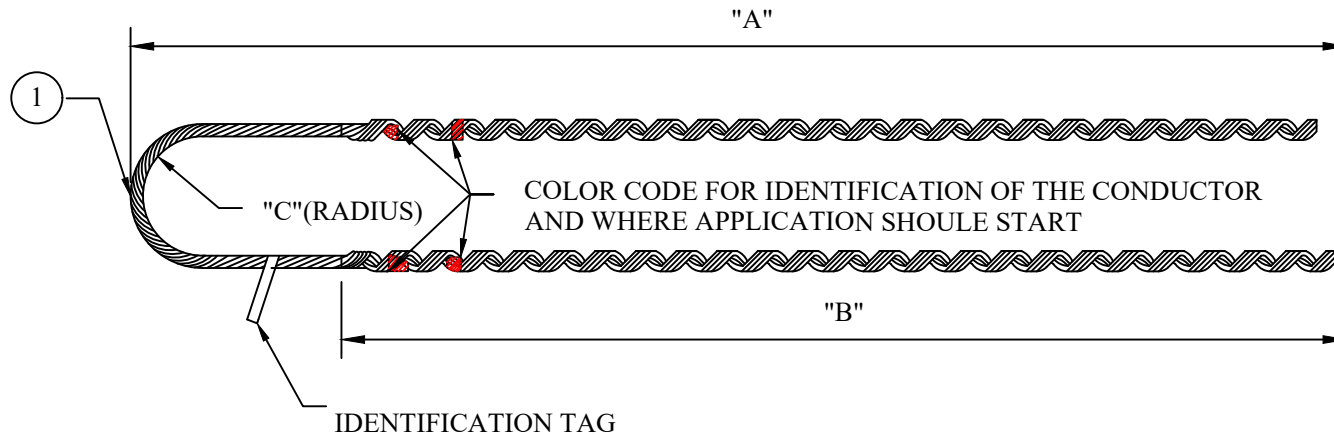

NOTES:

1. ALL DIMENSIONS FOR REFERENCE ONLY. SIDTANCE. [MM], FORCE LBS. [kN], TORQUE IN. LBS. [N.m], & WEIGHT LBS. [KG].
2. RATINGS:
 - A. ALL GUY WIRE DEAD-ENDS MEET 100% OF THE WIRE RATED BREAKING STRENGTH(RBS) AS SHOWN IN TABLE
3. CERTIFICATIONS, SPECIFICATIONS, & STANDARDS:
 - A. NA
4. SUFFIXS & VARIANT CONFIGURATION
 - A. NA
5. HAND LAY DIRECTION: LEFT

DRN BY:	DATA
Ella	07/09/16
<small>CONFIDENTIAL. THIS DRAWING AND ITS CONTENTS PROPERTY OF TIANJIN TUOFA ELECTRIC POWER TECHNOLOGY CO., LTD. NO PUBLICATION, DISTRIBUTION OR COPIES MAY BE MADE WITHOUT THE WRITTEN CONSENT OF TIANJIN TUOFA ELECTRIC POWER TECHNOLOGY CO., LTD. TIANJIN TUOFA ELECTRIC POWER TECHNOLOGY CO., LTD. UNPUBLISHED ALL RIGHTS RESERVED UNDER THE COPYRIGHT LAWS.</small>	

ALUMINUM CLAD FORMED
WIRE DEADEND, 25M



TTF POWER TECHNOLOGY CO.